

## First Floor

- |                  |                   |                                    |   |
|------------------|-------------------|------------------------------------|---|
| 1. Library       | 5. Bookstore      | 9. President's Office              | 13. Medicinal Herb Garden & Reflexology Foot Path |
| 2. Classroom 186 | 6. Classroom 146  | 10. Conference Services Department | 14. Sacred Seeds Ethnobotanical Trail             |
| 3. Classroom 184 | 7. Dining Commons | 11. Student Village                |   |
| 4. Auditorium    | 8. Chapel         | 12. Teaching Greenhouse            |   |

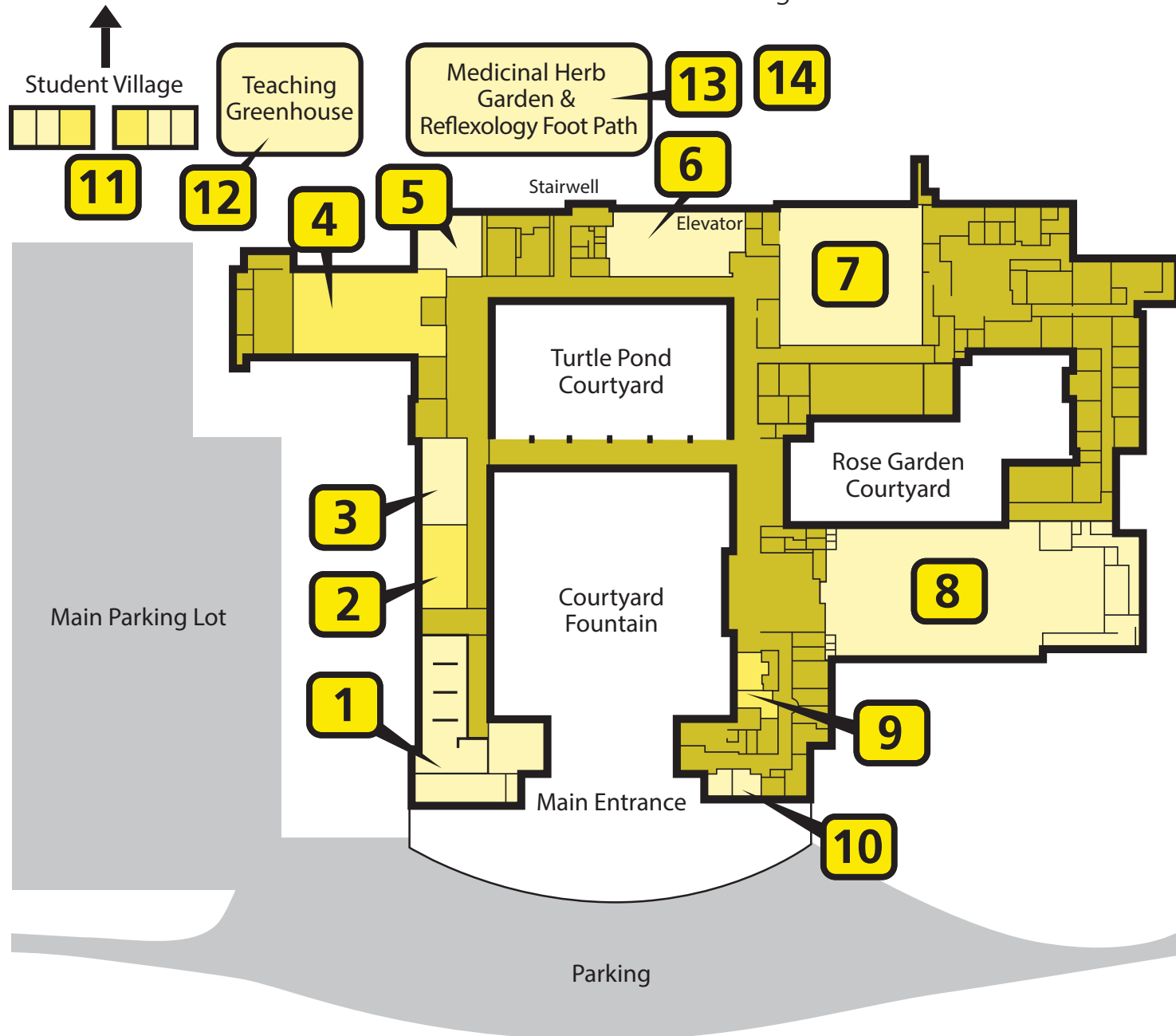

## Second Floor

- |                   |                               |
|-------------------|-------------------------------|
| 14. Classroom 286 | 16. Student Services Room 249 |
| 15. Classroom 284 | • Admissions                  |
|                   | • Financial Aid               |
|                   | • Registrar                   |

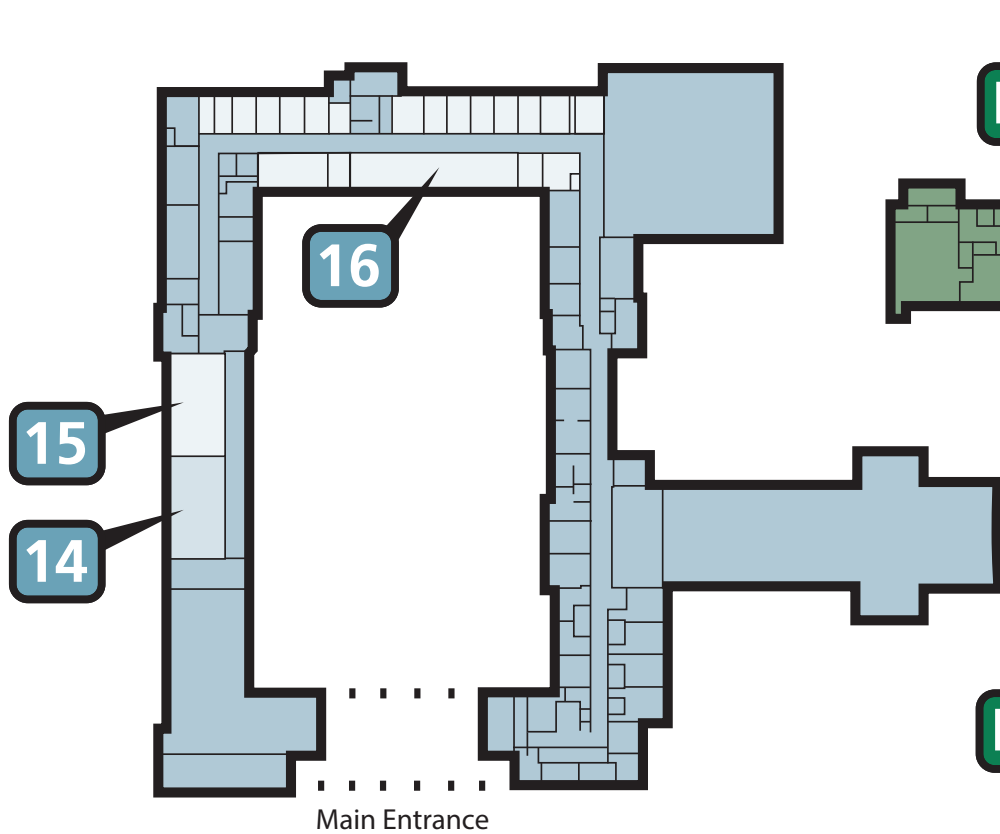

## Basement

- |   |                          |
|---|--------------------------|
| B1. Tierney Basic Sciences Research Lab     | B4. Nutrition Kitchen    |
| B2. Botanical Medicine Lab                  | B5. Exercise Science Lab |
| B3. Acupuncture and East Asian Medicine Lab | B6. Movement Room        |
|   | B7. Student Computer Lab |

